

| Item | Description | Part | QTY |
|------|--------------------|-------|-----|
| 1 | Head Bolt M6x55 | 1001 | 4 |
| 2 | Spring washer 6 | 1002 | 4 |
| 3 | Cylinder head | 1002 | 1 |
| 4 | Exhaust elbow | 1004A | 1 |
| 5 | Gasket | 1005 | 1 |
| 6 | Valve assembly | 1006 | 1 |
| 7 | Gasket | 1007 | 1 |
| 8 | Cylinder | 1008A | 1 |
| 9 | Piston | 1009A | 1 |
| 10 | Piston air ring | 1010H | 2 |
| 11 | Piston oil ring | 1010L | 1 |
| 12 | Piston pin clip | 1011A | 2 |
| 13 | Piston pin | 1012A | 1 |
| 14 | Connecting rod | 1013A | 1 |
| 15 | Gasket | 1014 | 1 |
| 16 | Bolt M8*25 | 1015 | 2 |
| 17 | Spring washer 8 | 1016 | 2 |
| 18 | Crankshaft | 1017A | 1 |
| 19 | Bolt M8*22-LH | 1018 | 1 |
| 20 | Crank case gasket | 1019 | 1 |
| 21 | Crank case cover | 1020 | 1 |
| 21a | Bolt M6*10 | 1021 | 1 |
| 22 | Seal | 1022 | 1 |
| 23 | Oil sight glass | 1023 | 1 |
| 24 | Bolt M6*18 | 1024 | 4 |
| 25 | Breather | 1025 | 1 |
| 26 | Crank case | 1026 | 1 |
| 27 | Oil seal | 1027 | 1 |
| 28 | Bearing | 1028 | 1 |
| 29 | Rotator | 1900 | 1 |
| 30 | Bearing | 1030 | 1 |
| 31 | Stator | 1900A | 1 |
| 32 | Spring washer wave | 1032 | 1 |
| 33 | Rear cap | 1033 | 1 |
| 34 | Spring washer 5 | 1034 | 4 |
| 35 | Bolt M5 | 1035 | 4 |
| 36 | Fan | 1036 | 1 |
| 37 | Circlips | 1037 | 1 |
| 38 | Capacitor | 1038 | 1 |
| 39 | Washer 3 | 1039 | 1 |
| 40 | Spring washer 3 | 1040 | 1 |
| 41 | Bolt M3*6 | 1041 | 1 |
| 42 | Shroud | 1042A | 1 |

| Item | Description | Part | QTY |
|------|--------------------|-------|-----|
| 43 | Bolt M5*15 | 1043 | 6 |
| 44 | Pressure switch | 1044A | 1 |
| 45 | Connector | 1045 | 1 |
| 46 | Connector | 1850 | 1 |
| 47 | Pressure gauge | 1047T | 2 |
| 48 | Connector | 1048 | 1 |
| 49 | Regulator | 1049 | 1 |
| 50 | Quick connect | 1050T | 1 |
| 51 | Safety valve | 1051A | 1 |
| 52 | Strain relief | 1052 | 2 |
| 53 | Power cord | 1053 | 1 |
| 54 | Terminal (O) | 1054 | 1 |
| 55 | Terminal (Y) | 1055 | 2 |
| 56 | Tank | 1223 | 1 |
| 57 | Check valve | 1062A | 1 |
| 58 | Drain valve | 1061 | 1 |
| 59 | Exhaust nut | 1063 | 1 |
| 60 | Exhaust pipe | 1173 | 2 |
| 61 | Tube | 1313 | 1 |
| 62 | Nut | 1066 | 1 |
| 63 | Handle | 1650A | 1 |
| 64 | Bolt | 1481 | 2 |
| 65 | Wheel | 1480 | 2 |
| 66 | Nut | 1482 | 2 |
| 67 | Bolt | 1800 | 2 |
| 68 | Nut | 1500 | 2 |
| 69 | Washer | 1059 | 2 |
| 70 | Cushion foot | 1058 | 2 |
| 71 | Bolt | 1501 | 2 |
| 72 | Overload protector | 1067 | 1 |
| 73 | Air filter | 1068 | 1 |

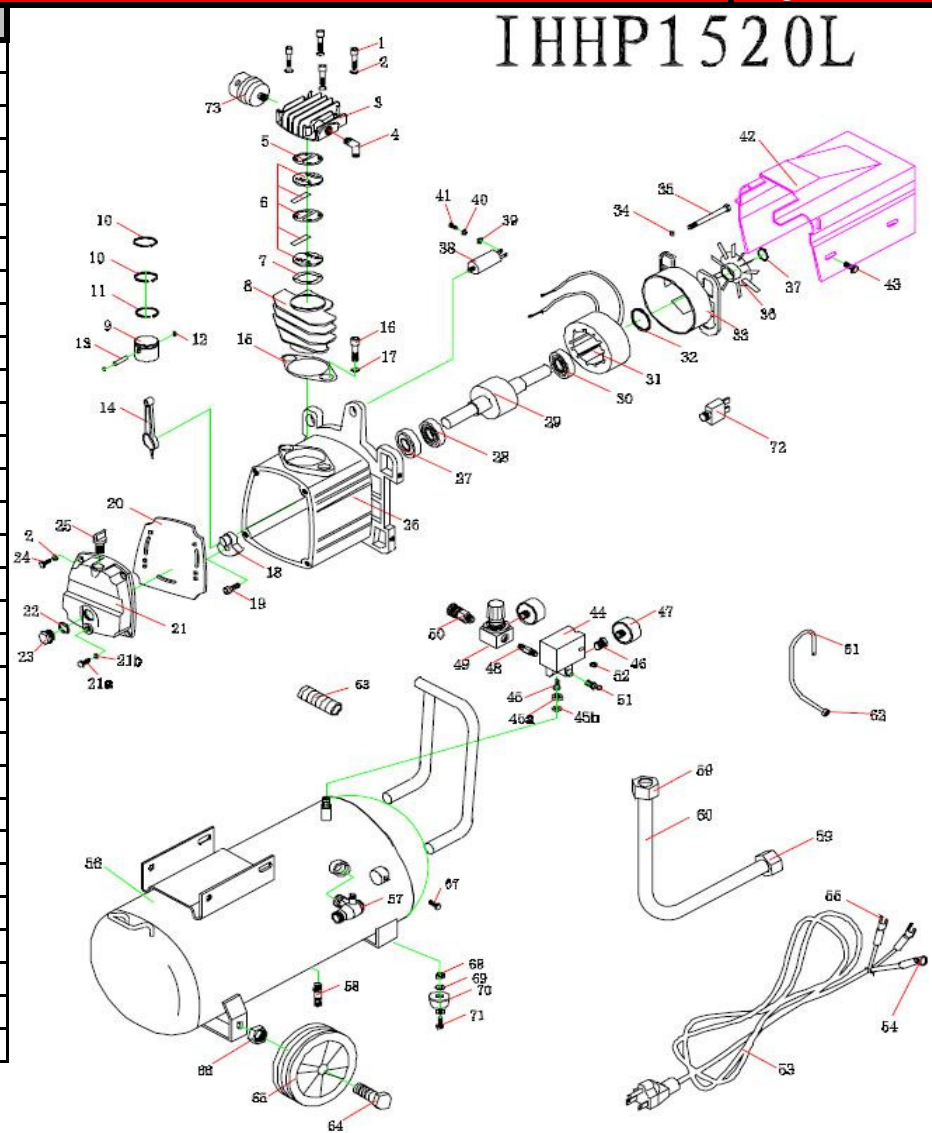

IRON HORSE

EAGLE
PUMP & COMPRESSOR LTD.

1-800-551-2406

www.eaglecompressor.com