

Item	Description	Part	QTY
1	Head Bolt M6x55	1001	4
2	Spring washer 6	1002	4
3	Cylinder head	1002	1
4	Exhaust elbow	1004A	1
5	Gasket	1005	1
6	Valve assembly	1006	1
7	Gasket	1007	1
8	Cylinder	1008B	1
9	Piston	1009B	1
10	Piston air ring	1010M	2
11	Piston oil ring	1010N	1
12	Piston pin clip	1011B	2
13	Piston pin	1012B	1
14	Connecting rod	1013B	1
15	Gasket	1014	1
16	Bolt M8*25	1015	2
17	Spring washer 8	1016	2
18	Crankshaft	1017A	1
19	Bolt M8*22-LH	1018	1
20	Crank case gasket	1019	1
21	Crank case cover	1020	1
21a	Bolt M6*10	1021	1
22	Seal	1022	1
23	Oil sight glass	1023	1
24	Bolt M6*18	1024	4
25	Breather	1025	1
26	Crank case	1026	1
27	Oil seal	1027	1
28	Bearing	1028	1
29	Rotator	1900	1
30	Bearing	1030	1
31	Stator	1900A	1
32	Spring washer wave	1032	1
33	Rear cap	1033	1
34	Spring washer 5	1034	4
35	Bolt M5	1035	4
36	Fan	1036	1
37	Circlips	1037	1
38	Capacitor	1038	1
39	Washer 3	1039	1
40	Spring washer 3	1040	1
41	Bolt M3*6	1041	1
42	Shroud	1042A	1

Item	Description	Part	QTY
43	Bolt M5*15	1043	6
44	Bolt M8*55	1350	4
45	Washer 8	1059	4
46	Nut 8	1351	4
47	Pressure switch	1044A	1
48	Connector	1048	1
49	Regulator	1049	1
50	Connector	1850	1
51	Pressure gauge	1047T	2
52	Plug	1360	1
53	Quick connect	1050A	1
54	Strain relief	1052	1
55	Power cord	1053	1
56	Terminal (O)	1054	1
57	Terminal (Y)	1055	2
58	Handle grip	1650	1
59	Tank	1220	1
60	Custion foot	1058A	4
61	Washer 6	1059A	4
62	Bolt	1060A	4
63	Check valve	1062A	1
64	Safety valve	1051A	1
65	Drain valve	1061	1
66	Tube nut	1066	1
67	Tube	1310	1
68	Exhaust nut	1063	1
69	Exhaust pipe	1170	1
70	Nut	1063	1
71	Air filter	1068	1
72	Overload protector (15A)	1067	1

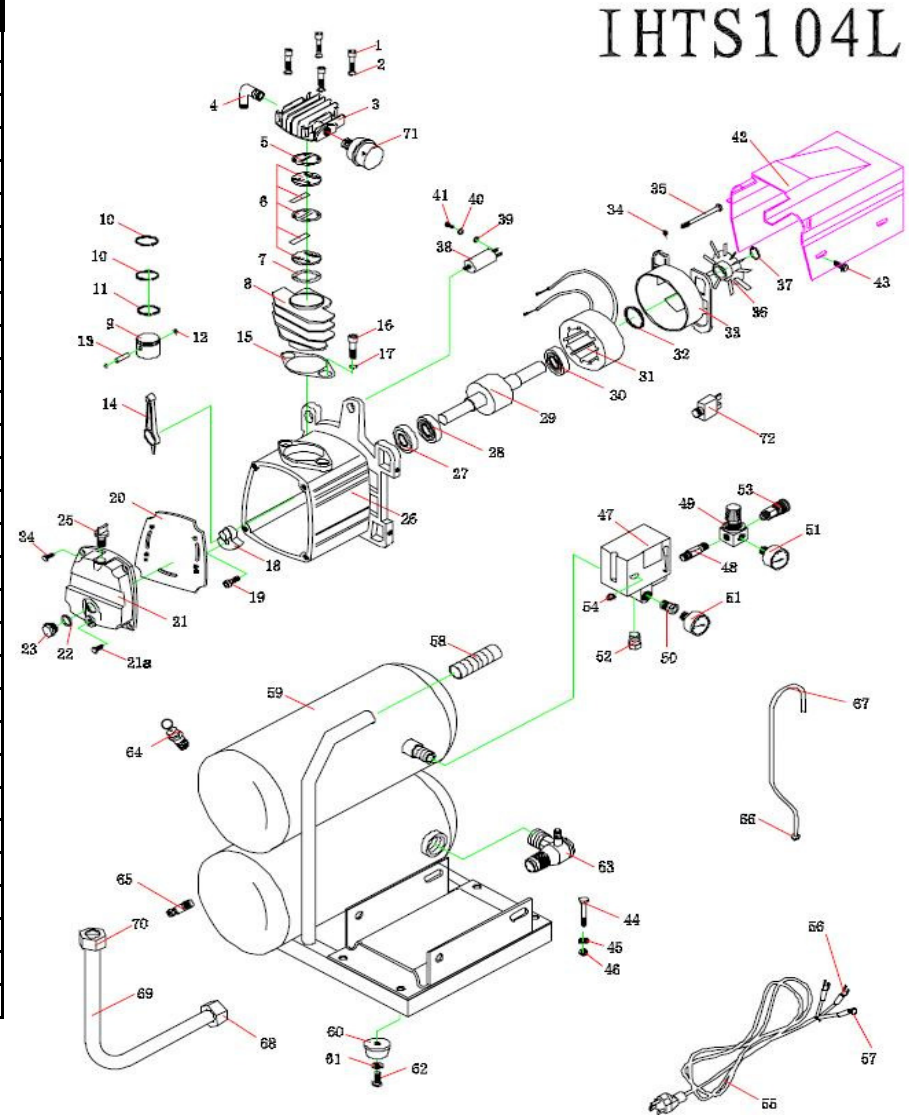

IRON HORSE

EAGLE™
PUMP & COMPRESSOR LTD.

1-800-551-2406

www.eaglecompressor.com