

## Eagle Air Compressor part breakdown sheet - Single Stage Stationary Units (Horizontal)

Item	Description	C7180H1	C7*80H1	C10*120H1
1	Compressor w/ Flywheel	PV05A	PV05A	PT10A
2	Discharge Tube	TU-2634-1A	TU-2634-1A	TU-15-1
	Flare Fitting/Elbow	N/A	N/A	F041S-16SP & 49-16H
3	Pressure Gauge	PG200-2.5R	PG200-2.5R	PG200-2.5R
4	Outlet Valve	BV3/4MF	BV3/4MF	VA1
5	Air Receiver	80HE20X63-B	80HE20X63-B	120HE24X68-B
6	Drain Cock	DC1/4	DC1/4	DC1/4
7	V-Belt	A73 (2)	A73 (2)	B89
8	Belt Guard	BG80GAL	BG80GAL	BG10
9	Motor - 1 Phase, 208/230V	EM07.5-18-10	N/A	N/A
	- 3 Phase, 208/230-460V	N/A	EM07.5-18-30	EM10.0-18-30
	- 3 Phase, 575V	N/A	EM07.5-18-50	EM10.0-18-50
10	Check Valve	P1010S-T	P1010S-T	P1010S-T
11	Pressure Switch	21UCBDB	21UCBDB	21UCBDB
12	Pulley - Motor	2MAL82	2MAL82	2B9.4PD
13	Hub or Bushing	LX13/8	LX13/8	SK13/8
14	Unloader Tube w/ Fittings	TU-1/4-CU & 68-4A	TU-1/4-CU & 68-4A	TU-1/4-CU & 68-4A
15	Safety Valve	PSV1/4-150	PSV1/4-150	PSV1/4-150
	Eagle Compressor Oil	EAOIL10	EAOIL10	EAOIL10

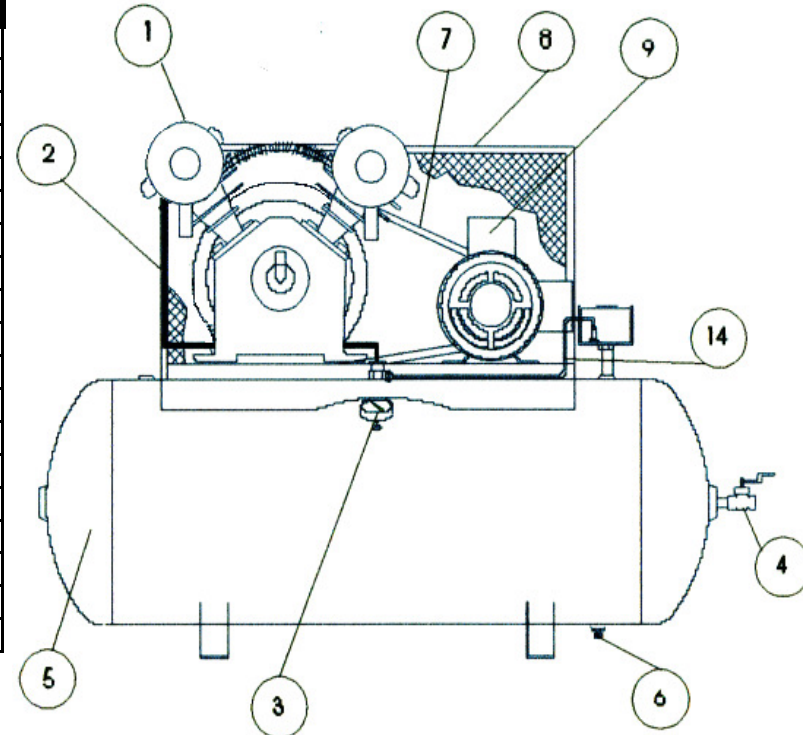

\* For C7180H1-MS - add Magnetic Starter part # MS60981104

\* For C7380H1-CS4 - substitute part #11 for CS-10/16A

\* For C103120H1-MS208 - add Magnetic Starter part #FFDC420

\* For C103120H1-MS230 - add Magnetic Starter part #QFGB320

\* For C7380H1-CS2 - sub part #11 for CS-20/24A

\* For C7580H1-CS - sub part #11 for CS-6.3/10A

\* For C103120H1-CS460 - sub part #11 for CS-10/16A

\* For C105120H1-CS - sub part #11 for CS-6.3/10A

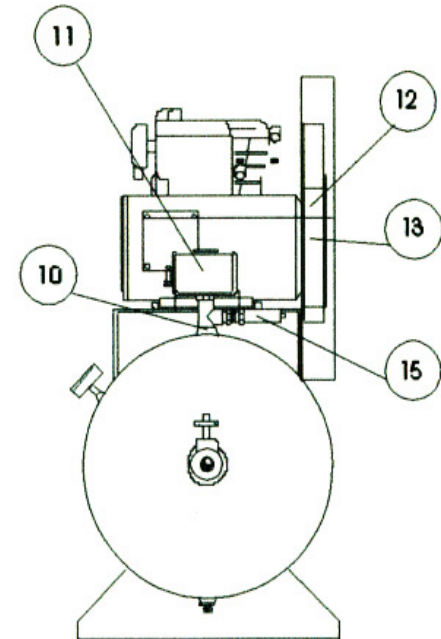

### MODELS

C7180H1	C103120H1
C7180H1-MS	C103120H1-MS208
C7380H1	C103120H1-MS230
C7380H1-CS2	C103120H1-CS460
C7380H1-CS4	C105120H1
C7580H1	C105120H1-CS
C7580H1-CS	



# EAGLE

