

Iron Horse Air Compressor part breakdown - IHP5120H1-US

Item	Description	IHP5120H1-US
1	Compressor w/ Flywheel	CC2051
2	Discharge Tube w/ Fittings	TU-20-AL
3	Check Valve	CTF1/2X1/2
4	Electric Motor	EM03.0-36-1OSP-CH
5	Pulley - Motor	MA33X5/8
6	V-Belt	4L450
7	Belt Guard	BG20GAL
8	Air Receiver	20HEPORT-T
9	Pressure Gauge (Tank)	PG200-2.0BO1/4
10	Drain Cock	DC1/4
11	Safety Valve	PSV1/4-150
12	Pressure Switch	21UCBDB-CH
13	Wiring Harness	12/3-13-PT
14	Wheel	PT-WHEEL
	Shoulder Bolt	E5004
15	Vibration Damper	TT-FOOT
16	Unloader Tubing w/ Fittings	TU1/4BLK
17	Power Cord	12/3-72-PT
18	Ball Valve	BV1/4MF

IRON HORSE



IHP5120H1-US

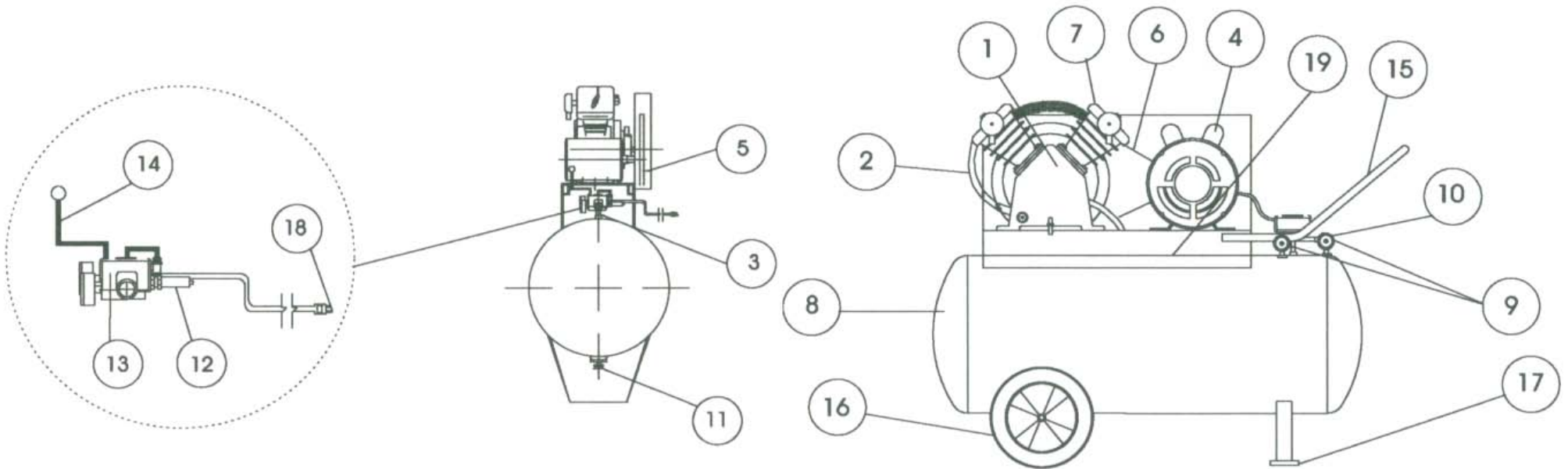

Call 1-800-551-2406 for the Customer Service Department.

Iron Horse Air Compressor part breakdown - IHP5120V1-US

Item	Description	IHP5120V1-US
1	Compressor w/ Flywheel	CC2051
2	Discharge Tube w/ Fittings	TU-20-AL
3	Check Valve	CTF1/2X1/2
4	Electric Motor	EM03.0-36-1OSP-CH
5	Pulley - Motor	MA33X5/8
6	V-Belt	4L450
7	Belt Guard	BG20GAL
8	Air Receiver	20VEPORT-T
9	Pressure Gauge (Tank)	PG200-2.0BO1/4
10	Drain Cock	DC1/4
11	Safety Valve	PSV1/4-150
12	Pressure Switch	21UCBDB-CH
13	Wiring Harness	12/3-13-PT
14	Wheel	PT-WHEEL
	Shoulder Bolt	E5004
15	Vibration Damper	TT-FOOT
16	Unloader Tubing w/ Fittings	TU1/4BLK
17	Power Cord	12/3-72-PT
18	Ball Valve	BV1/4MF

IRON HORSE

Wood INDUSTRIES INCORPORATED

IHP5120V1-US

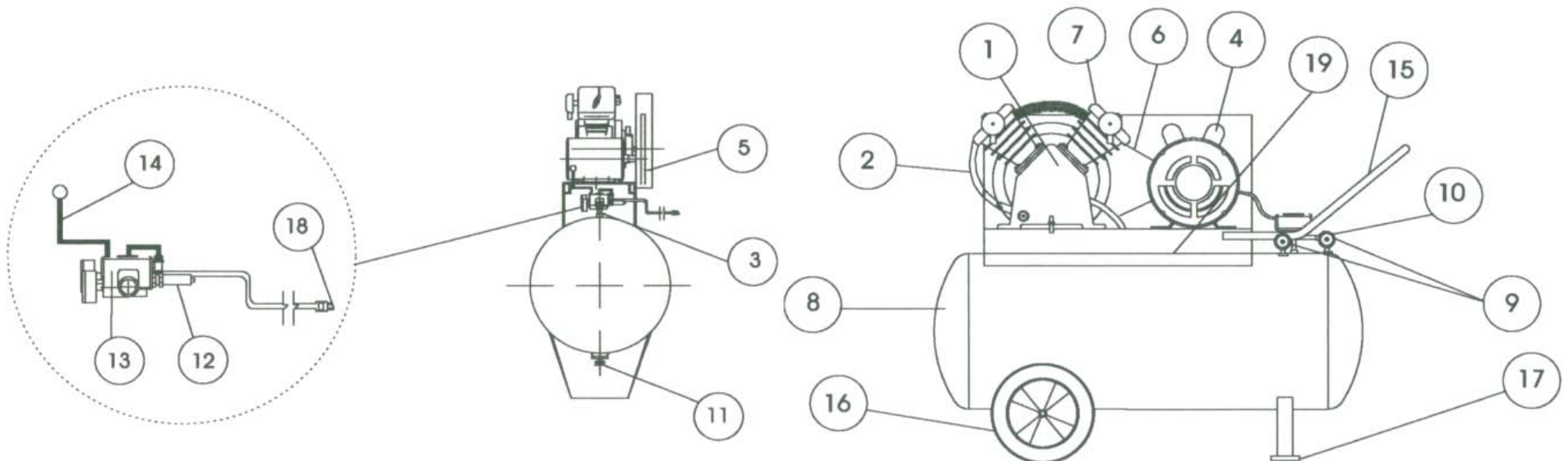

PICTURE OF 20 GAL VERTICAL NOT AVAILABLE AT THIS TIME

Call 1-800-551-2406 for the Customer Service Department.